



GB / T 20234



No.: CQC16029149670

AC Charging Connector for Electric Vehicle : GB / T 20234 Standard

PTCG2A032D0-G0 / PTCG2A016D0-G0

Vehicle connector



Plug

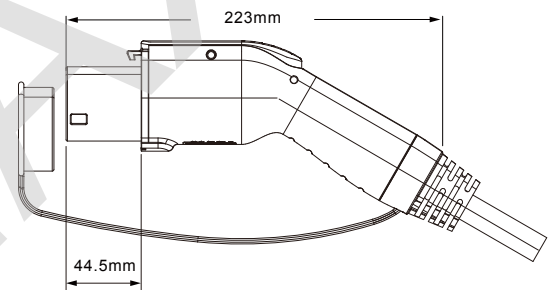
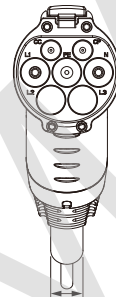
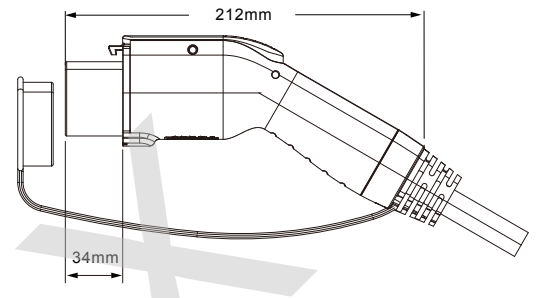
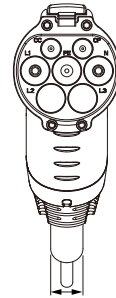

Features

- Conformity in surface design with GB / T 20234-2015.
- Ergonomic and streamlined designs allow for user-friendly interaction.
- High protection level to resist severe environment.
- Products passed 5000N driveover test.
- Applicable to connection B and Connection C of IEC 61851.

Application

BEV, PHEV, Charging pile, cord set, domestic wall-mounted charger, etc.

Charging mode : mode2 / mode3 ; Type of connection : Case B.



GB 20234



AC mode



Water Proof



Dust Proof



Wide Range Temp.



Product Perimeter

Project

Specification

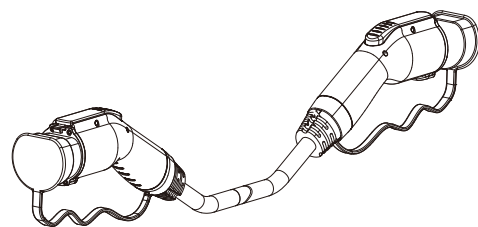

Vehicle Connector Color
 Rated Current
 Rated Voltage
 Force
 Lifespan
 Flammability Rating
 Protection Level
 Operating temperature
 Main Material
 TATC Application No.

Black
 32A / 16A
 250V AC
 $\leq 100N$
 ≥ 10000 times
 UL 94V-0
 With Cap IP54 , Body IP67
 $-30^{\circ}C \sim +50^{\circ}C$
 PBT/PC/PA66/Copper alloy
 16A: QA16EE1EB0812 / QA16EF1EB0812
 32A: QA16EE1EB0822 / QA16EF1EB0822

AC Charging Cable Spec.

Specification

Color

Standard

32A Cable
 16A Cable

$3 \times 6.0mm^2 + 1 \times 0.75mm^2$
 $3 \times 2.5mm^2 + 1 \times 0.75mm^2$

Black
 Black

GB / T 33594
 GB / T 33594